

SS70-B-60(25) - SPEEDLINE System Data Sheet - Version V1 (24-10-23)

Staggered SPEEDLINE 70mm 'I' Stud Partition
@600mm Ctrs with 2x BG Gyproc 15mm
SoundBloc each side, 25mm APR

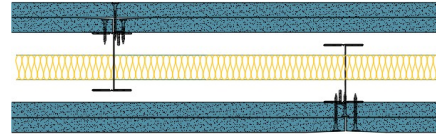

System Performance Breakdown

Fire Resistance:

BS476 Part 22:1987:

Test Ref & Date or Applied Ref & Report:

Max Height:

Thickness:

Duty Grade: BS 5234: Part 2:1992:

Sound Insulation:

90/90 Minutes (Integrity/Insulation).

BRE Report P102396-1011A

Refer to Speedline Specification Clause

154 mm. (At Base Track, Excluding Finishes)

Severe - Annexes A-F

58 R_w dB, -8 Ctr Date Tested or Assessed Against - SS60-B-60(25)

Test Code:
H17553AA
Test Date:
25/08/2011

Freq. Hz	R dB
50	25.5
63	18.6
80	25.4
100	35.4
125	34.8
160	40.3
200	50.2
250	50.6
315	52.8
400	57.5
500	60.1
630	62.6
800	65.0
1 000	66.8
1 250	67.7
1 600	68.5
2 000	64.1
2 500	55.3
3 150	56.9
4 000	62.0
5 000	64.7
6 300	
8 000	
10 000	

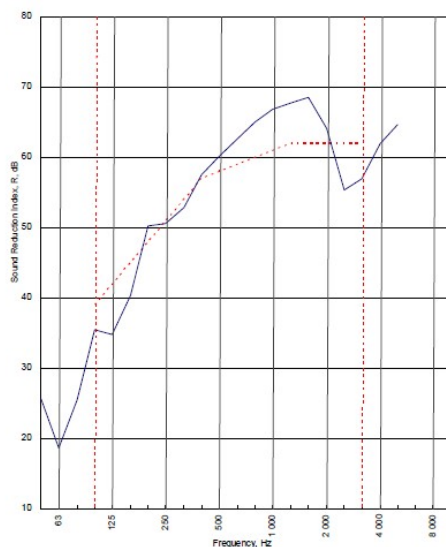

R_w (C;Ctr) = 58 (-3;-8) dB
Max dev. 7.2 dB at 125 Hz

Rating according to
BS EN ISO 717-1:1997

Evaluation based on laboratory
measurement results obtained by
an engineering method:

C_{50-500} = -7 dB $C_{50-1000}$ = -6 dB $C_{100-5000}$ = -2 dB
 $C_{50-1100}$ = -18 dB $C_{50-5000}$ = -18 dB $C_{100-5000}$ = -8 dB

TESTED AT ONE OF THE UKAS
ACCREDITED LABORATORIES
BELOW

B.T.C
(H-Ref on Graph)

B.R.E

AIRO

S.R.L



Customer: Metsec plc Hepsec Division

BTC 17553A: Page 9 of 11



SPEEDLINE Drywall Systems, Adsetts House, 16 Europa View, Sheffield Business Park, Sheffield, S9 1XH.

Tel: 0114 231 8030.

Email: enquiries@speedlinedrywall.co.uk

(As per the requirements set out in ISO/IEC 17025:2017 regarding test data the results stated have been carried out by voestalpine Metsec plc as part of the contract to supply Speedline Metal Sections to SIG Plc)